

Technical Information
Mount Baker Theatre

104 N. Commercial Street, Bellingham, WA 98225

Office: 360-733-5793, FAX: 360-671-0114

E-mail: info@mountbakertheatre.com

WEB-SITE: <http://www.mountbakertheatre.com>

MOUNT BAKER THEATRE

Revision – September 2023

TABLE OF CONTENTS

Theatre Staff Contact Numbers	2
Policies	3
Management and Load-In Information	4
Carpentry (Dimensions)	5-6
Lighting.....	7-8
Sound	9-12
Props and Wardrobe.....	13-14
Line Set Schedule	15
Stage Area Floor Plan.....	16
Theatre Section	17
Small Spaces Technical Specifications.....	18

Theatre Staff

Executive Director.....John Purdie, 360-738-7375
Facilities & Operations Director.....Jim Zoehrer, 360-738-7376
Program Director & Venue RentalsRenee Gaumont, 360-738-7508
Marketing Director.....Meghan Hurley, 360-734-4950
Patron Services Director.....Aaron Gunderson, 360-647-6356
Finance Director.....Matt Bilderback, 360-738-7459
Arts Education Coordinator.....Christina Feinberg, 360-734-1016
Event Services Manager.....Valerie Leslie, 360-738-7413
House & Hospitality Manager.....Adrienne Schnabel, 360-398-6508
House Manager.....Andre Carrao, 360-398-6508
Ops Assistant & Production Manager.....Caitlyn Ward, 360-778-4013
Finance Assistant.....Mary Walby, 360-398-6099
Administrative Assistant.....Dawn Wefer, 360-778-4006
Concessions & Merchandise Supervisor....Trevor Lichterman, 360-778-4019
House Lead Technician – Audio..Christoffer “Toffer” Eriksen, 360-778-4014
House Lead Technician – Lighting..... Audrey Henderson, 360-778-4015
Box Office Manager.....Tyler Jo Holmes, 360-738-7458
Assistant Box Office Manager.....Chelanne Evans, 360-734-6080
Environmental Services.....Rodrigo Bergucio-Garcia, 360-733-5793
Digital Marketing Manager.....Lorin Lindell, 360-778-4005
Graphic Design Manager.....Allison Sowder, 360-398-6799
Development Specialist.....Relli Robino, 360-738-7378
Corporate Development Specialist.....Jack Klages, 360-738-7377
Admin. Offices:.....360-733-5793
Ticketing Office:360-734-6080
FAX:360-671-0114

Policies

Parking: The Mount Baker Theatre controls a limited amount of parking for visiting artists and staff, including temporary parking for unloading and loading trucks in the alley behind the stage. Limited shore power is available for buses or trucks at the theatre. All personnel involved in events at the theatre are responsible for their own parking and under no circumstances are allowed to park in the alley or in the passenger loading zone in front of the theatre. Vehicles parked in violation of this policy may be ticketed and towed at the expense of the owner(s).

Smoking & Vaping: Smoking and or Vaping is only permitted outside the building. Smoking and or Vaping is not permitted on stage or in the wings unless it is an integral part of the performance or dress rehearsal.

Security: The theatre provides lockable door security in areas under its authority, unless otherwise requested, and no additional locks on theatre doors will be permitted. The theatre does not take responsibility for the loss of any personal property or artist equipment while it is in the theatre. Valuables should not be left in dressing rooms. The theatre recommends that the renter designate a representative to collect and keep the renter's valuables until the performance is completed.

Sound Level: Mount Baker Theatre respects the artistic rights of performers regarding their sound, and the rights of staff and audiences to enjoy working and attending performances that do not have a cumulative negative effect on their hearing. Mount Baker Theatre's nearly 100-year-old plaster has been damaged by excessive volume in the past. Therefore, MBT enforces a sustained sound level maximum of 90 decibels (90db) and peak [less than four (4) minutes cumulative each show] sound level maximum up to 100 decibels (100db). The measurement will be conducted at the sound board at the back of house using A-weighting at a slow response by MBT technicians familiar with venue and audience tolerance.

Mount Baker Theatre requires touring consoles to be routed through the house console to sound system speakers. Failure to comply with this policy will result in a charge of 5% of gross ticket sales being assessed to the artists or renters at time of settlement. To protect our patrons, our staff, and our building, flagrant disregard for this policy will result in additional charges.

Piano Use and Tuning: The theatre has three pianos:

1. 1963 Steinway 9' (2.74m) Model D Concert Grand Piano with Artist Bench, owned by the Bellingham Symphony Orchestra.
2. Yamaha DGB1KE 5' Baby Grand Piano with Disklavier Unit
3. Baldwin Upright Piano, owned by the Mount Baker Youth Symphony.

The Facilities & Operations Director approves all use of the pianos. The pianos will be tuned only to A-440. No food, beverages, ashtrays, cigarettes, equipment, tools, props or other items are to be placed on the pianos. The pianos are not available for use outside the theatre. Only personnel provided by the theatre may move the pianos. This includes moving the pianos in and out of storage areas. Pianists may only make minor adjustments to the piano's location or orientation to the audience. Pianos will only be played at the keyboard and not used to create special effects inside, i.e., "prepared piano." Piano tuners provided by or approved by the theatre will perform all tuning of the pianos. No one except approved piano tuners may attempt to change the tuning of the piano. The theatre will repair any damage to the piano(s) caused by violating these policies or caused by any other reason, and the charges will be billed to the responsible individual or organization.

Additional Props: Other than the facilities specified herein, the renter shall supply such additional sets, properties, and other articles or devices necessary for each event as delineated in their specific contracts.

Management

Road Manager's Office: Backstage with Internet access. Fax machine is in the Administration Office. Wireless internet access is available. Password will supply when you arrive.

Crews: Mount Baker Theatre operates under a collective bargaining agreement with the International Alliance of Theatrical Stage Employees and Motion Picture Operators locals 15 and 887. The stage crew minimum for the Main Stage is three stage crew (sound, lights, fly / deck). The stage crew minimum for Walton Theatre & Encore Room is one room tech. For crew scheduling and information, contact the Facilities & Operations Director or Production Manager.

Stagehands - IATSE #15, Seattle, WA. 206-441-1515.

Wardrobe - IATSE #887, Seattle WA. 206-443-9354.

Handicapped Access: Wheelchair ramp to dressing rooms, same level as stage.

Load-In Area

Dimensions: Loading door is 14' (4.27m) wide by 10' (3.05m) high. It is through the left wall of the stage, which egresses into the alley. A permanent drawbridge style aluminum dock with a weight capacity of 2000lbs is provided that is 14' (4.27m) wide by 1'10" (55.88cm) high and 9' (2.74m) long; a ramp must be provided. Depending on conditions, vehicles must be moved unless on or off loading.

Carpentry

Seating: 1509 seats, 8 Wheelchair spaces.

Stage Dimensions:

Proscenium: 22' 1" (6.78m) high by 45' (13.72m) wide. Fire Curtain to back wall is 26' (7.92m). Fire Curtain to arched apron edge is 14' (4.26m) maximum on center.

Wing space: Stage right 13' 6" (4.11m). Stage left 16' 6" (5.03m)

Grid height: 47' (14.33m)

Orchestra Pit: Pit cover apron must be removed for use.

Stage height: 4' (1.22m) above the auditorium floor.

Stage floor: 1/4" Masonite Painted Black on top of 1/2" MDO Plywood on top of 3/4" MDO Plywood sitting on neoprene gaskets. This surface is resting on 4" (10.16cm) by 4" (10.16cm) crosshatched sleepers on 16" (40.64cm) centers. It is in good condition. It is painted black. Lagging to the deck is permitted, but pre-drilling is REQUIRED. No traps or elevators.

House Draperies (Soft Goods):

House Curtain: Regal Red 25oz. (7.09gram) velour with gold trim. Draw or guillotine. Located at lineset #2, 1' 3" (.38m) from plaster line. Manual operation only.

Legs: 4 pairs, black 25oz. (7.09gram) velour, 8' (2.44m) wide by 23' (7m) high, sewn flat.

Traveler: Black, 25oz. (7.09gram) velour in two, 30' wide (9.14m) by 23' (7m) high, pieces, which are of 50% fullness and unlined.

Borders: 5 black 25oz. (7.09gram) velour, 54' (16.46m) wide by 4' (1.22m) high, sewn flat.
2 black 25oz. (7.09gram) Velour, 50' wide by 10' high sewn flat.

Scrim: Black 50' (15.24m) wide by 23' (7m) tall sharks tooth scrim.

Full Stage: Black, 25oz. (7.09gram) velour, in two pieces 30' (9.14m) wide by 23' (7m) high, sewn flat.

Cyclorama: White, 54' (16.09m) wide by 23' (7m) high, seamless bleached natural muslin.

Support Areas:

Crossover: A hall behind the stage that runs almost full length and is 3'10" (1.14m) wide.

Access: House access from the stage is by stairs on both SR and SL. With the exception of the loading door, the only access to the stage is located at the ends of the crossover hall, which itself accesses all dressing rooms, green room, production office and road office.

Lineset Data:

Lineset Plot: See attachment.

Working height of battens: The maximum "high trim" is 46' (14.02m). The maximum "low trim" is 5' (1.52m) above the stage floor.

Battens: 49-55' (16.76m), 1 ½" schedule 40 pipe, on 6" centers (15.24cm), 7 lift lines. Pipes may be married.

Type: Single purchase, H&H T-Track.

Arbor capacity: 800 lbs. (362.88Kg) per pipe.

Available weight: 10,000 lbs. (4,536Kg) on loading gallery.

Loading gallery: Stage right with caged access ladder and is 43' (15.55m) above the wing.

Pin rail: Stage right with caged access ladder and is 31' (9.45m).

Power:

Lighting:

Panel #1: 208v 3φ 400 amps (304.8kVA), located USL

Panel #2: 208v 3φ 200 amps (152.4kVA), located USL

Isolated Audio:

A total of 225amps 208 3φ Shared in the following areas.

Audio Disconnect #1: 208v 3φ 200 amps located USL

Audio Disconnect #2: 208v 3φ 100 amps located DSR

Audio Disconnect #3: 208v 3φ 60 amps Located DSR

Floor Pockets: 6 floor pockets(3 SR & 3 SL) 110v 30amps L5-30 Twist

Aux Power: 6 110v 20amp Edison Located DSR by audio panel

House Monitor Power: 6 L21-30 Receptacles (3 DSL & 3 DSR) 208v 3φ 30amp

FOH Power: 1 L5-30 110v 30amp, 2 110vac quad boxes.

All disconnect locations have neutral, ground and are fused with lug taps for tie in.

All disconnects are within 30' (9.14m) of the proscenium.

All audio power receptacles are Isolated and Orange in color.

Lighting

Dimmers: Strand CD 80, 24 X 1.2K and 36 X 2.4K, ETC 24 x 2.4K for a total of 24 1.2K and 60 2.4K For the Main Stage. An additional 3 12 X 2.4K ETC dimmers are available in the Walton Theatre if there is not another event in the Walton Theatre. Dimmers conform to the DMX 512 1990 protocol.

Circuits: 1kw Socapex, “soft house” movable using L5-20 3 pin twist connectors. 14 Socapex breakout “drop” boxes with six circuits each.

Front of House Position: There is ONLY 1 FOH Lighting position in this house. 50’ (15.24m) of 20” (50.8cm) box truss 20’ (6.09m) from the proscenium, trimmed at 24’ giving approximately a 52° angle to the extreme lip of the apron. If your show requires a higher trim height, a rigger will have to be called for focusing the front truss.

Control Console: Chamsys MQ500M Stadium Console with MQ500M Wing running MagicQ software v1.9.4.6, utilizing 4 sACN & 2 standard DMX Universes for a total of 6 universes (house hang uses 2 universes). Manual, video tutorials, and software can be found online here: [Chamsys](#).

House Lights: House and architectural lights are operated by an ETC Unison Touch Screen. Touch screens are located at FOH, stage left and can be stage right.

Stage Lights:

Stage Lighting Inventory:

- 23-Strand 6” Fresnel’s 1kw
 - 24-Aluminum PAR64’s 1kw (lamped w/medium or wide lamps)
 - 12-ETC Source 4 Parnell’s
 - 6 – GLP Impression E350 Moving Head Profile [GLP Lighting](#) (27 Chan. mode), 9750 – 12,200 lumens, 8.5 deg – 42 deg Zoom, Full CMY Color Mixing, 565 deg pan, 256 deg tilt
 - 12-GLP Impression X4 Moving Head Wash [GLP Lighting](#) (21 Chan. Mode), 36 – 1145 lumens, 7 deg – 50deg Zoom, Full CMY Color Mixing, 660 deg pan, 295 deg tilt
 - 10-LED Par64 3 Watt (RGB) (6 Chan. Mode) ~25 deg, 162 lumens
 - 9-LED Altman Spectra Cyc 100 (RGBA) [Altman](#) (10 Chan. Mode) 4727 lumens
 - 12-LED COLORdash Par-Quad 18 (RGBA) [Chauvet](#) (10 Chan. Mode) 32.5 deg, 1210 lumens
 - 17-575w Style Source 4 Bodies
 - 64-750w Style Source 4 Bodies (Lamped at 575w)
 - 24-19° Source 4 Lens Tubes
 - 30-26° Source 4 Lens Tubes
 - 36-36° Source 4 Lens Tubes
 - 12 -50° Source 4 Lens Tubes
 - 9 - Strand 2220 20° Lekos 1kw
 - 12-Strand 2230 30° Lekos 1kw
 - 16-Strand 2240 40° Lekos 1kw
 - 6 - Strand 3-cell Cyc bays 1kw
- ** All instruments are L5-20 Twist. **
- ** Inventory is shared between main stage and the Walton Theatre **

Typical Rep Hang for the FOH Position:

17 Source Four 36°
10 Source Four 19°
4 GLP Impression E350 Moving Head Profile
10 LED 3-watt (RGB) Color Key (6 Chan. Mode) (Frosted with Half Hats)
36 total circuits available FOH. (24-1K and 12-2K)

Typical Rep Hang for the 1st Electric:

4 ETC Source4 36deg as High Sides, (32 Off SL, 2 Off SR) single circuit.
10 Par 64 1k Wide equally spaced, 1 per dimmer.
4 GLP Impression X4 Moving Head Wash
5 Source 4 50° 575w equally spaced, single circuit.

Typical Rep Hang for the 2nd Electric:

4 ETC Source4 36deg as High Sides, (2 Off SL, 2 Off SR) single circuit.
10 Par 64 1k Wide equally spaced, 1 per dimmer.
4 GLP Impression X4 Moving Head Wash
3 Source 4 36° 575w equally spaced, single circuit.

Typical Rep Hang for the 3rd Electric:

4 ETC Source4 26deg as High Sides, (2 Off SL, 2 Off SR) single circuit.
4 GLP Impression X4 Moving Head Wash
3 Source 4 36° 575w equally spaced, single circuit.

Typical Rep Hang for the 4th Electric

7 Strand 6" 1k Fresnel's equally spaced, 2 per dimmer.

Typical Rep Hang for the 5th Electric:

9 LED Spectra Cyc 100 (RGBA)

Followspots: 2 Lycian M2 2.5K's, permanently positioned in upper corners of balcony.

Accessories: Please Ask

Cable: 1146' (349.42m) in the following lengths: 6'6" (2m), 16'5" (5m) and 32'10" (10m) of 12 AWG with TLG ends.

Video Projection Equipment:

- Digital Projection M-Vision 21000 WU
 - 1080P HD (1920x1200) 16:10
- Sanyo PDG-DHT8000L 8000 Lumens
 - 1080P HD (1920x1080) 16:9

Sound

Power: See Power Section above.

Wiring: Soundcraft Vi 64/32 C5 Stagebox and MADI Audio Network enabling full Audio Access SR or SL.

Audio / Video / Lighting Control Runs: All Cable runs to the front of house position will be run from the center of the orchestra pit into the air plenum along a cable tray to the control position. You will need at least 175' of control cable. There are no exceptions to this under any circumstances.

Control Locations: Permanent House center rear position on main floor under a shallow balcony. A 150' (45.72m) snake is necessary to reach the position. The console position has the following measurements: 3' (.91m) high by 4'1/2" (1.27m) wide and 13'7" (4.14m) long. With a total of 30a power available from panel #3.

Hearing Assist System: The house has a Listen Technologies LT-800 Transmitter with 16 patron receivers. The hearing assist system is used for all shows. A line out from your system will be necessary.

Monitor/Paging System: For Backstage monitors, the line is split from the assisted listening system to the Clear Com system. The Clear Com system provides all monitor and paging to the dressing rooms. If you need paging a separate send to the clear com system will be needed.

Production Communications: Clear Com Eclipse Pico Digital Com System. 10-RS 601 belt packs, 17-CC95 single muff and 1 CC260 double muff headsets. Locations are Projection booth, Followspots, FOH console, SR, SL, Pin Rail, Loading Rail, and Orchestra Pit Hall.

Radio Communications: The house staff uses radios during setup and the show run. This is very important to our operations and must be used. If your show has issues with the frequencies we are using please let us know in advance. We have alternative channels we can use. Our 2 main frequencies have 5 side band channels we can choose from. We will work with you to find clear air space for your show to use.

We have the following frequencies on our radios.

464.5000 MHz (5 side channels we can choose from)

464.5500 MHz (5 side channels we can choose from)

461.3625 MHz

464.4875 MHz

464.5375 MHz

466.0375 MHz

466.0875 MHz

466.1375 MHz

Audio Equipment Inventory:

FOH

Mixing Console: Sound Craft VI3000

Inputs:

- ** (All Channels can have internal effects etc inserted)
- 48 Inputs on Console, Balanced XLR, 64 Inputs on Stage box, 96 Input busses
- 1 MADI Card
- 1 ViO/D21 Blu Link Card
- 1 Talkback Mic Input on front of console

Outputs:

- 8 Outputs on Console, 32 Outputs on Stage box
- 24 output Busses
- Main Masters - L,C, & R Outputs
- ** (27 BSS 30-band Graphic EQs are permanently assigned to the 24 Output busses and the 3 main masters) **
- Soundcraft manual available at [Soundcraft](http://www.soundcraft.com)

FOH Mixing Assist Monitors:

- 2 Genelec 8040B on stands

Playback:

- 1 Dell Precision 3260 Computer 32gb RAM, Intel Core i7-7700CPU @3.6ghz, NVIDIA 510 GPU 2gb RAM, Asus Essence STX Audio, Blu-Ray Drive, DVD-R Drive

Signal Processing:

- The VI3000 has 4 Lexicon Effects Processing units
- 1 BSS BLU160M.

Amplifiers:

- 4 L'Acoustics LA12 X amplifier controllers (mains) 4x1400w @ 8Ω
- 1 L'Acoustics LA4X amplifier controller (center) 4x100w @ 8Ω
- 1 L'Acoustics LA2Xi amplifier controller (fill) 4x370w @ 8Ω

All amplifiers are permanently rack mounted DSR.

House Mains:

- 18 L'Acoustics Model Kara II Line Array Two Way Speakers (mains) @ 8Ω
- ** 9 of each is flown HL and HR just downstage of proscenium.
- 3 L'Acoustics Model A15 Wide Two Way Speakers (center) @ 8Ω (flown)
- 6 L'Acoustics Model SB18i Subwoofer Speakers (subs) 700w RMS @ 8Ω
- ** 3 per side on stage level sound wings.
- 6 L'Acoustics Model 5XT Short Throw Two-way Speakers (fill) @ 8Ω
- Mounted on Orchestra Pit Rail

Monitor System:

Mixing Console: Sound Craft VI1

Inputs:

- ** (All Channels can have internal effects etc inserted)
- 32 Inputs on Console, Balanced XLR, 64 Inputs from Stage Box
- 1 Madi Card
- 1 Talkback Mic Input on front of console

Outputs:

- 24 output Busses
- Main Masters - L,C, & R Outputs
- ** (27 BSS 30-band Graphic EQs are permanently assigned to the 24 Output busses and the 3 main masters)
- Soundcraft manual available at [Soundcraft](#)

Monitor Amp Racks:

- 3 Amp Racks with following gear per rack; can support up to 12 monitor sends (4 per rack Bi amp)
- 2 – Ashly GQX 2 Channel 31-Band Equalizer
- 4 – Crown XT14000 Amplifiers

Monitor Speakers:

- 8 – Radian Apex-NEO 1200XD Low Profile Wedges. (12" 2 way)
Wedges are 12-1/2" (317mm) X 12-1/2" (368mm) X 21-1/2" (546mm)
- 4 – Radian Apex-1500 Low Profile Wedges. (15" 2 way)
Wedges are 14-3/4" (374mm) X 17-1/2" (445mm) X 22-3/4" (578mm)

In Ear Monitors:

- 10 – Sennheiser IEMG4 Transmitters & Receivers w/ universal ear buds

Microphones, Wired:

- | | |
|-----------------------------------|-------------------|
| 2 – AKG C-480B | 1 – Shure Beta 52 |
| 4 – Audio Technica C-87MKII | 12 – Shure SM57 |
| 3 – Audix D6 | 1 – Shure Beta 57 |
| 3 – Audix OM-7 | 11 – Shure SM58 |
| 3 – Crown PCC-160 | 2 – Shure SM94 |
| 2 – KSM 32 | |
| 8 – Sennheiser E604 | |
| 8 – Sennheiser E609 | |
| 3 – Sennheiser E901 | |
| 2 – Sennheiser E914 | |
| 6 – Sennheiser E935 | |
| 2 – Sennheiser MD441-U | |
| 2 – Sennheiser MD421 | |
| 2 – Sennheiser MKH 50 P48 Shotgun | |

Microphones, Wireless:

- 6 – Sennheiser ew100g3 Wireless Receivers
- 6 – Sennheiser e835 Handheld Wireless
- 6 – Sennheiser Body Packs
 - 2 – Lapel Style Mics for Body Packs
 - 6 – Countryman e6 over-ear style Mics for Body Packs.
 - 30 - Countryman b3 Mics for Body Packs.
 - 2—Instrument cables for Body Packs
 - 2 – Sennheiser e908
 - 2 – Sennheiser HSP

DI's:

- 6 – Klark Teknik active DI's
- 2 – Proco passive DI's
- 2 – Rapco DB100 Passive DI's
- 4 – Rapco SL2passive DI's
- 1 – Rapco SL4

Microphone Stands:

- 28 – tall tripod stands w/ booms
- 6 – medium tripod stands w/ booms
- 8 – cast base short stands w/ booms
- 11 – cast base straight stands (5 Black, 6 Chrome)

Back Line

- 1 – Steinway Model D 9' Grand piano
- 1 – Upright Piano (In Encore Room)*
 - a. To use this piano in any other room, Moving and retuning fees apply
- 1 – Yamaha Model DGB1KE 5' Baby Grand with Disklavier recording & playback system (In Walton Theatre)*
 - a. To use this piano in any other room, Moving and retuning fees apply
- 4 – Tympani drums
- 1 – Bass drum

PROPS

Orchestra Pit: 39' (11.89m) long by 9'9" (2.97m) wide and 5' (1.52m) deep. It can accommodate about 15 musicians and is located below a removable 13' (3.96m) stage extension.

Chairs: 94 Black, Orchestra chairs.

Stands: 70 Black, Manhasset, Orchestra Music stands.

Stand Lights: 48

Conductor Podium: 1 3' (.91m) by 3' (.91m) and 9" (22.86cm) with black carpet.

Platforms:

8 - 4' (1.22m) wide by 8' (2.44m) long by 24" (.61m) high

6 - 4' (1.22m) wide by 8' (2.44m) long by 16" (.41m) high

4 - 4' (1.22m) wide by 8' (2.44m) long by 8" (.20m) high

Lecterns: 2 non-adjustable wood.

Stage Equipment and Furniture:

6-29" (.99m) Bar Stools

2-Handcart's

2-Flat dollies 2' (.61m) by 2' (.61m)

1-6' (1.83m) ladder

1-20' (6.10m) A-frame ladder

1-25' (7.62m) Stick ladder

1-25' Man Lift, Self-Propelled

WARDROBE

Dressing Rooms:

Old area behind stage:

- 2-13' 8" (4.19m) long by 9'9" (2.99m) wide, sink, clothes hanger, counter, mirrors, and make-up lights.
- 2-9'11"(3.02m) long by 6'6" (1.98m) wide, sink, counter, mirrors, make-up lights and built in 4' 5"(1.36m) clothes hanger.
- 2 restrooms with sink, mirror and 1 shower each.

** The Old Dressing room area egress into the crossover hall backstage. **

New Dressing rooms Up Stage Right:

2 Chorus Dressing rooms (Seats about 20) with Counters, Mirrors, Lights, Private Restroom / Shower

1 Principal Dressing Room with Counter, Mirror, Lights, and a Private Restroom/Shower

1 Wardrobe room with the following equipment:

Irons: 2

Ironing boards: 2

Steamers: 1

Washers/dryers: 1 each of Whirlpool (no charge)

Racks and hangers: 5 racks 5'2" (1.58m) high by 3'2" (.98m) wide

Quick Change Booths: 1-8' (2.44m) high by 4'3" (1.28m) wide by 4'3" (1.28m) deep, with toggle for mirror, black fabric cover over flat

1 Green Room

Attachment # 1 Line Set Schedule

MBT Tech Packet Lineset Schedule DEC2023

Line	To Plaster Line	Use	Weight	Remarks
0	0'-3"(0.8m)	Fire Curtain		Permanent
1	0'-9"(2.3m)	Teaser	4 Pigs	Permanent (Guillotine)
2	1'-3"(3.8m)	House Act Curtain	28 Pigs, 1 Wafer	Permanent (Draw or Guillotine)
3	1'-9"(5.3m)	Grand Legs	4 Pigs, 1 Wafer	House Masking, Can be struck
4	2'-3"(6.9m)		OUT OF SERVICE DUE TO DAMAGE	
5	2'-9"(8.4m)	1st Electric	17 Pigs, 1 wafer	House Electrics (Rep Plot)
6	3'-3"(9.9m)			Open
7	3'-9"(1.14m)	Lighting Ladders / Sidefills	3 Pigs	No Batten Installed
8	4'-3"(1.30m)			Open
9	4'-9"(1.45m)	Black Border, 10' Deep	1 Pig, 1 Wafer	House Masking
10	5'-3"(1.60m)	Black Legs	2 Pigs	House Masking, 19' off of center
11	5'-9"(1.75m)	Movie Screen	13 Pigs, 1 Wafer	Permanent, 22' Out Trim
12	6'-3"(1.90m)	Black Border, 4' Deep	1 Pig, 1 Wafer	House Masking
13	6'-9"(2.0m)			Open
14	7'-3"(2.20m)	Supertitle Screen	2 Pigs	Can be moved or struck
15	7'-9"(2.36m)			Open
16	8'-3"(2.51m)			Open
17	8'-9"(2.66m)	Black Border, 10' Deep	1 Pig, 1 Wafer	House Masking
18	9'-3"(2.81m)	Black Legs	2 Pigs	House Masking, 19' off of center
19	9'-9"(2.97m)			Open
20	10'-3"(3.12m)			Open
21	10'-9"(3.27m)			Open
22	11'-3"(3.42m)	2nd Electric	15 Pigs, 1 Wafer	House Electrics (Rep Plot)
23	11'-9"(3.58m)			Open
24	12'-3"(3.73m)			Open
25	12'-9"(3.88m)	Black Border, 4' Deep	1 Pig, 1 Wafer	House Masking
26	13'-3"(4.03m)	Black Bi Parting Traveler	16 Pigs, 1 Wafer	Permanent, House Masking
27	13'-9"(4.19m)			Open
28	14'-3"(4.34m)			Open
29	14'-9"(4.49m)	Work Lights	4 Pigs, 1 Wafer	Batten can be used if non-working
30	15'-3"(4.64m)			Open
31	15'-9"(4.80m)			Open
32	16'-3"(4.95m)			Open
33	16'-9"(5.10m)	Black Border, 10' Deep	1 Pig, 1 Wafer	House Masking
34	17'-3"(5.25m)	Black Legs	2 Pigs	House Masking, 19' off of center
35	17'-9"(5.41m)			Open
36	18'-3"(5.56m)	3rd Electric	10 Pigs, 1 Wafer	House Electrics (Rep Plot)
37	18'-9"(5.71m)			Open
38	19'-3"(5.86m)			Open
39	19'-9"(6.01m)			Open
40	20'-3"(6.17m)	4th Electric	6 Pigs	House Electrics (Fresnels)
41	20'-9"(6.32m)			Open
42	21'-3"(6.47m)	Black Border, 10' Deep	1 Pig, 1 Wafer	House Masking
43	21'-9"(6.62m)	Black Legs	2 Pigs	House Masking, 19' off of center
44	22'-3"(6.78m)			Open
45	22'-9"(6.93m)	5th Electric	5 Pigs	House Electrics (Cyc Bays)
46	23'-3"(7.08m)			Open
47	23'-9"(7.23m)			Open
48	24'-3"(7.39m)			Open
49	24'-9"(7.54m)	Full Black Drape	7 Pigs	2 sections
50	25'-3"(7.69m)	Full White Cyclorama	5 Pigs	Permanent

Smoke Pocket to
Back Wall Depth 25'4"

Pig Weight = 26lbs

SL Proscenium to
SR Proscenium
Width 44'8"

Wafer Weight = 12.6lbs

12/1/2023 9:58 PM

MOUNT BAKER THEATRE FLOOR PLAN (Not to Scale)

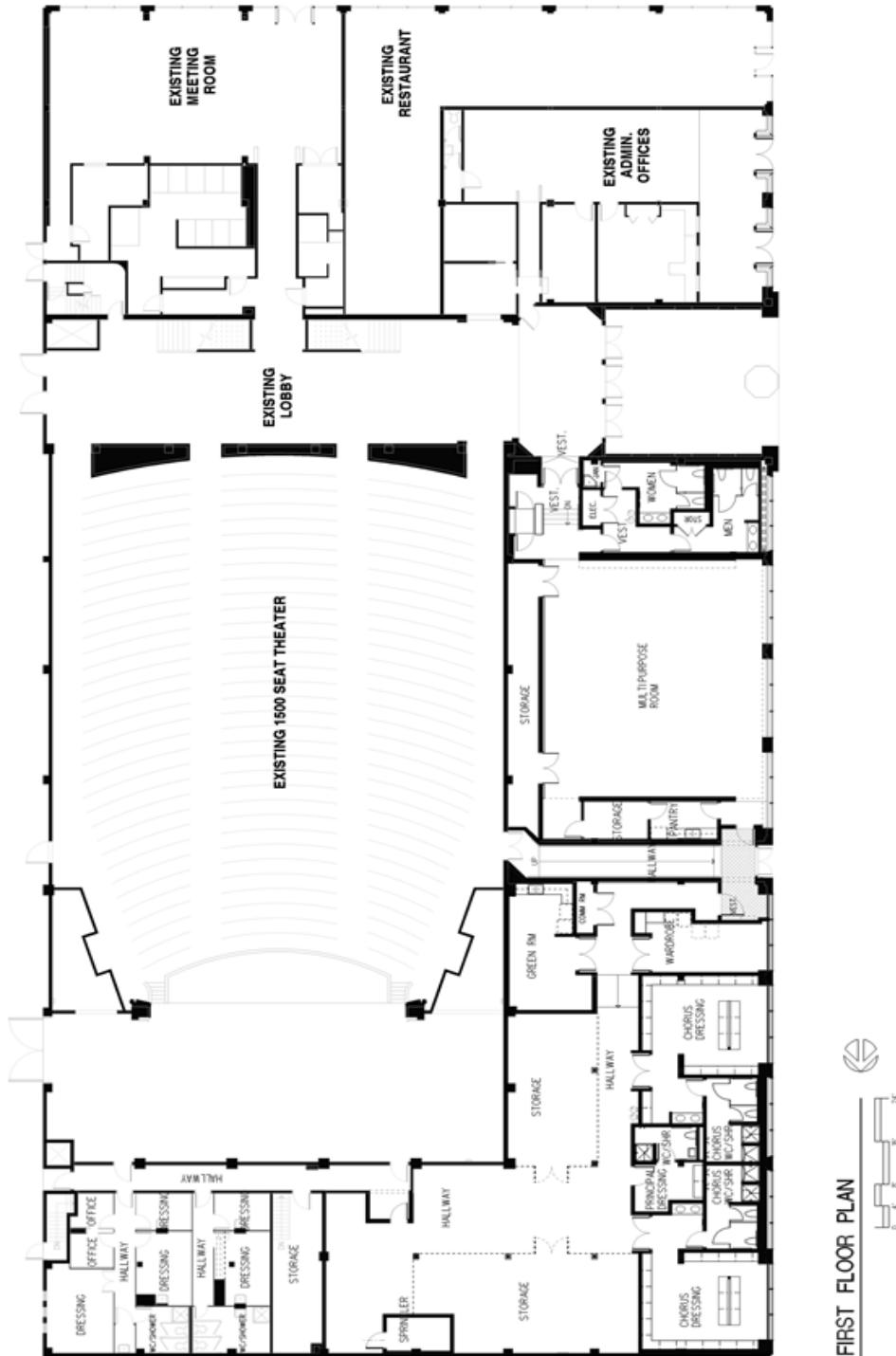

ATTACHMENT #3

THEATRE SECTION (Not to Scale)

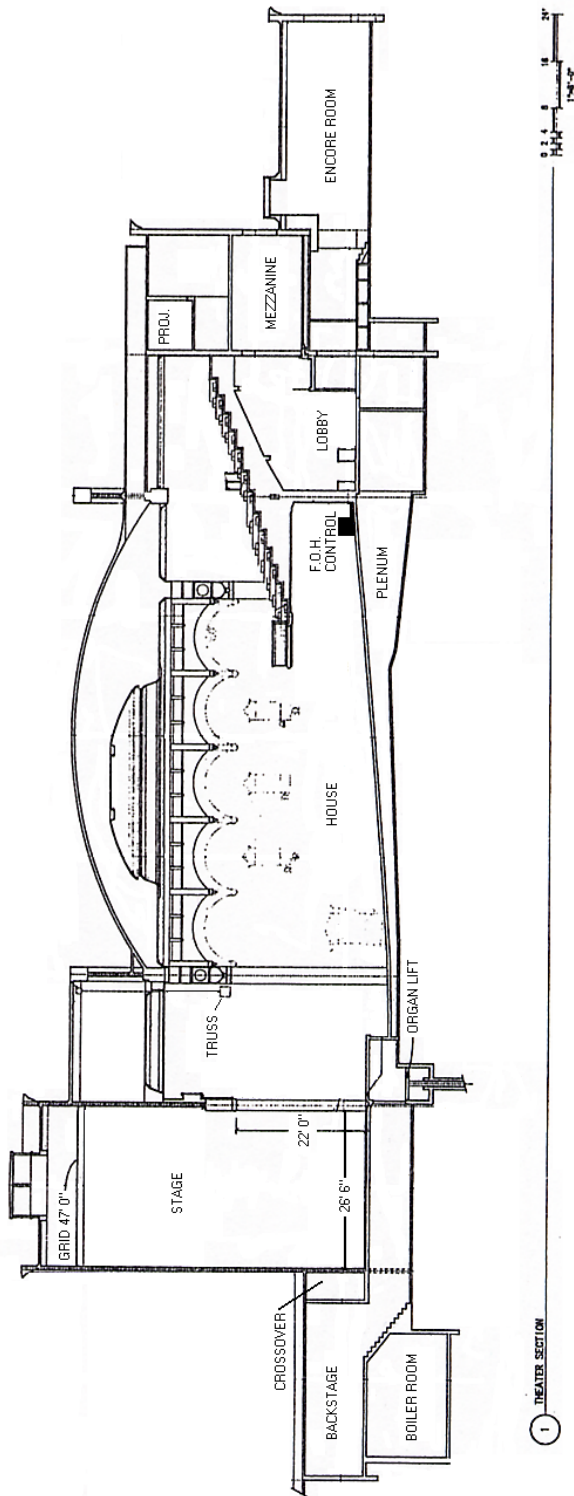

Small Spaces Technical Specifications

Walton Theatre

Dimensions:

43' 11" x 39'7" x 15'9"

1760 Square Feet

Power:

1ea. 208v 3 ϕ 225 amp (81.6kVA) Disconnect

10ea 120v 20-amp (2.4kVA) Outlets

Lighting:

Please See Lighting Inventory in MBT Technical Specifications Brochure

Audio:

1ea. Midas MR18 rackmount digital mixer

1ea. Yamaha GF 24/12 Control Console

1ea. 3 channel Rolls Microphone Control

1ea. Ashley Protea Processor

1ea. QSC ISA 280 Amplifier

1ea. Cloud CX-A200 Amplifier

4ea. JBL Speakers Mounted in Each Corner of Room, attached to Grid

6ea. Turbosound Speakers Mounted on SW Corner of Room, attached to grid

2ea. Sennheiser ew100 g3 Wireless Microphone Receivers and Belt Packs with Lavalier, Over the Ear (E6), or Through Wig Style (B3) Microphone Elements

2ea. Sennheiser ew835 Wireless Handheld Microphones

Wired Microphones & Stands:

Please See Audio Inventory in MBT Technical Specifications Brochure

Video:

1ea. ASK Proxima C440 LCD Projector 3500 Lumens

1ea. 115" Wide x 160" High Movie Screen

Video Playback Ability Available Upon Request

Staging & Soft Goods:

6ea. 4' (1.22m) wide by 8' (2.44m) long by 24" (.61m) high

8ea. 4' (1.22m) wide by 8' (2.44m) long by 16" (.41m) high

4ea. 4' (1.22m) wide by 8' (2.44m) long by 8" (.20m) high

16' x 24' Black Parquet Dance Floor

2ea. 6' wide x 15' High Black 24oz. Velour Legs with Fullness Sewn In

2ea. 15' Wide x 15' High Black 24oz. Velour Traveler Panels with Fullness Sewn In

1ea. 26' Bi Parting Traveler Track

8ea. 5'10" Wide x 12' 16oz Red Velour Pipe & Drape Panels Sewn Flat

6ea. 8' – 12' Telescoping Uprights with 18" Square Bases

8ea. 7' – 10' Telescoping Drape Bars

Seating Capabilities:

In the Round: 150 Patrons

Thrust: 127 Patrons

Proscenium: 145 - 160 Patrons, Depending upon Configuration

Banquet Rounds of 8: 80 Patrons (10 Tables)

Classroom: 82 Patrons (24 Tables)

Attachment #4 Continued

Encore Room

Dimensions:

51' x 28' x 10'

1428 Square Feet

Power:

5ea 120v 20-amp (2.4kVA) Outlets

Lighting:

8ea. Colortran Zoom Ellipsoidal Instruments Lamped at 350 watts

Please See Lighting Inventory in MBT Technical Specifications Brochure for Additional Lighting

Audio:

1ea. Peavey MMA 8150T 8 Channel Mixer Amplifier

4ea. JBL Speakers Mounted in Each Corner of Room, attached to Ceiling

2ea. Sennheiser ew100 g3 Wireless Microphone Receivers and Belt Packs with Lavalier, Over the Ear (E6), or Through Wig Style (B3) Microphone Elements

2ea. Sennheiser ew835 Wireless Handheld Microphones

Wired Microphones & Stands:

Please See Audio Inventory in MBT Technical Specifications Brochure

Video:

1ea. Optoma EP770 Projector 3000 Lumens

1ea. 115" Wide x 96" High Movie Screen

Video Playback Ability Available Upon Request

Staging & Soft Goods:

6ea. 4' (1.22m) wide by 8' (2.44m) long by 24" (.61m) high

8ea. 4' (1.22m) wide by 8' (2.44m) long by 16" (.41m) high

4ea. 4' (1.22m) wide by 8' (2.44m) long by 8" (.20m) high

16' x 24' Black Parquet Dance Floor

8ea. 5'10" Wide x 12' 16oz Red Velour Pipe & Drape Panels Sewn Flat

6ea. 8' – 12' Telescoping Uprights with 18" Square Bases

8ea. 7' – 10' Telescoping Drape Bars

Seating Capabilities:

Theatre: 100 Patrons

Banquet Rounds of 8: 64 Patrons (8 Tables)

Classroom: 46 Patrons (14 Tables)

Props / Miscellaneous:

Please See Props Inventory in MBT Technical Specifications Brochure